

ABARTH Fog Light Covers

INSTRUCTIONS

Before Installation:

1. Note that the 'ST' is the top and the 'line' or 'notch' is the bottom (picture 1).
2. The 'relief' is a feature that allows users to remove Fog Light Cover in the future using a small screwdriver or thin objects like a lolly stick.

WARNING: Do not apply pressure to the glass bulb!

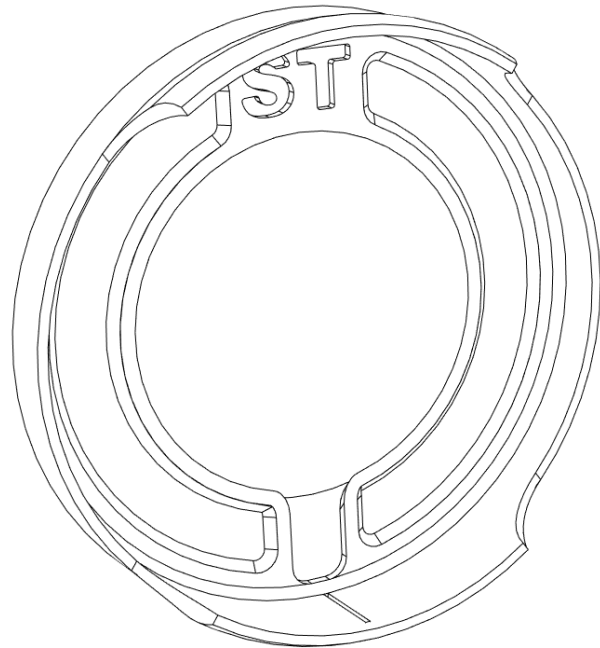

Step 1.

Clean the area using soapy water to remove grit and dirt.

Step 2.

Position the cover so that the 'ST' is at the top and the 'line / notch' is at the bottom.

Step 3.

Apply pressure to the cover until you hear a 'click' and proceed to press the cover gently around the fog light to ensure it has clipped on.

Step 4.

Step back and admire the front of your car!

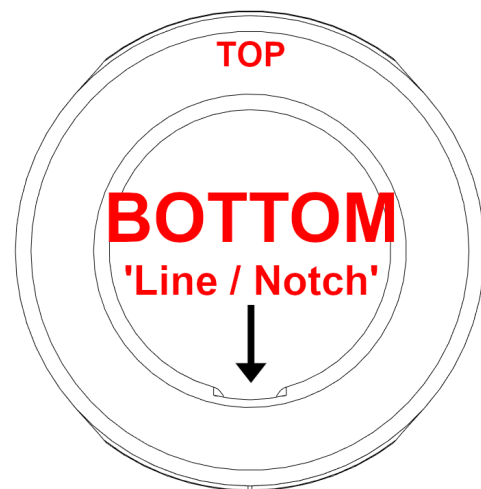

Thank you for your purchase with us!

